

# Township N<sup>o</sup> 111 N Range N<sup>o</sup> 40 W 5<sup>th</sup> Mer.

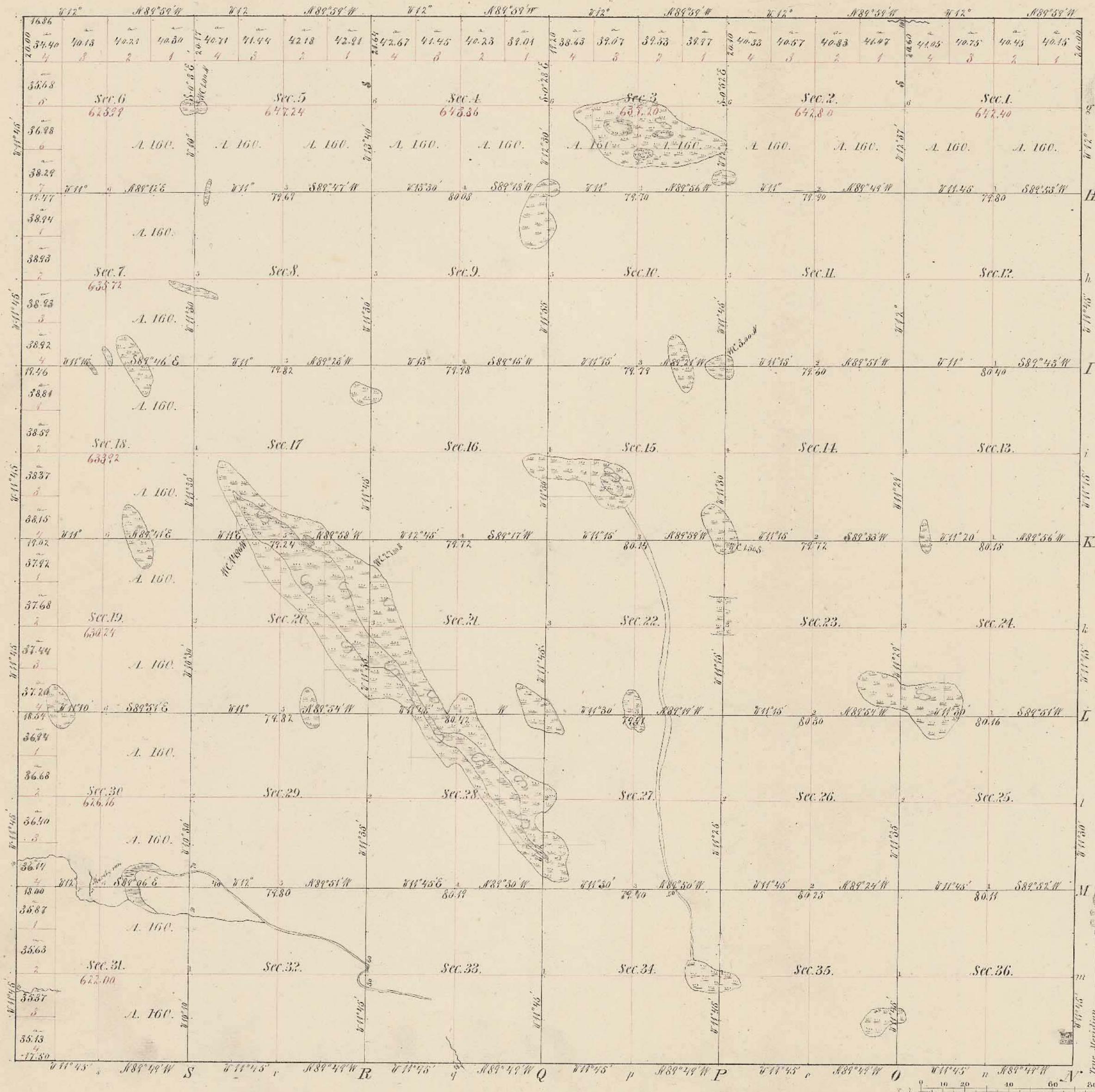

Meanders of					
Posts	Courses	Ch <sup>o</sup> Lk <sup>o</sup>	Posts	Courses	Ch <sup>o</sup> Lk <sup>o</sup>

**Total number of Acres. 27,987.03**

Surveys Designated	By Whom Surveyed	Date of Contract	Amount of Surveys	When Surveyed	When p <sup>d</sup> for and ch <sup>d</sup> in the Sur <sup>t</sup> Gen <sup>l</sup> acc <sup>t</sup>
Township lines	J. N. Bishop	May 26 <sup>th</sup> 1866	M. Ch <sup>o</sup> Lk <sup>o</sup>	1866	
Subdivisions	Jewett and Howe	April 6 <sup>th</sup> 1867	59 - 73 - 74	1867	

The above Map of Township N<sup>o</sup> 111 N of Range N<sup>o</sup> 40 W of the 5<sup>th</sup> Principal Meridian Minnesota is strictly conformable to the field notes of the survey thereof on file in this Office, which have been examined and approved.  
 Surveyor General's Office,  
 St. Paul Oct. 10. 1867  
*L. Keating* Sur. Gen.